

# Vickers® Steering



## Steering Cylinder

SC22-\*\*\*\*\*-11



**CAUTION**

The 922941, 1 1/8" end cap kit is no longer recommended for use on Vickers SC22 ball stud models. Replace with a 1 3/8" end cap kit 922922 and a 1 3/8" ball stud kit 923218. Check unit model number. The 922941, 1 1/8" end cap kit will be provided as a service item for models other than Vickers SC22 ball stud models.

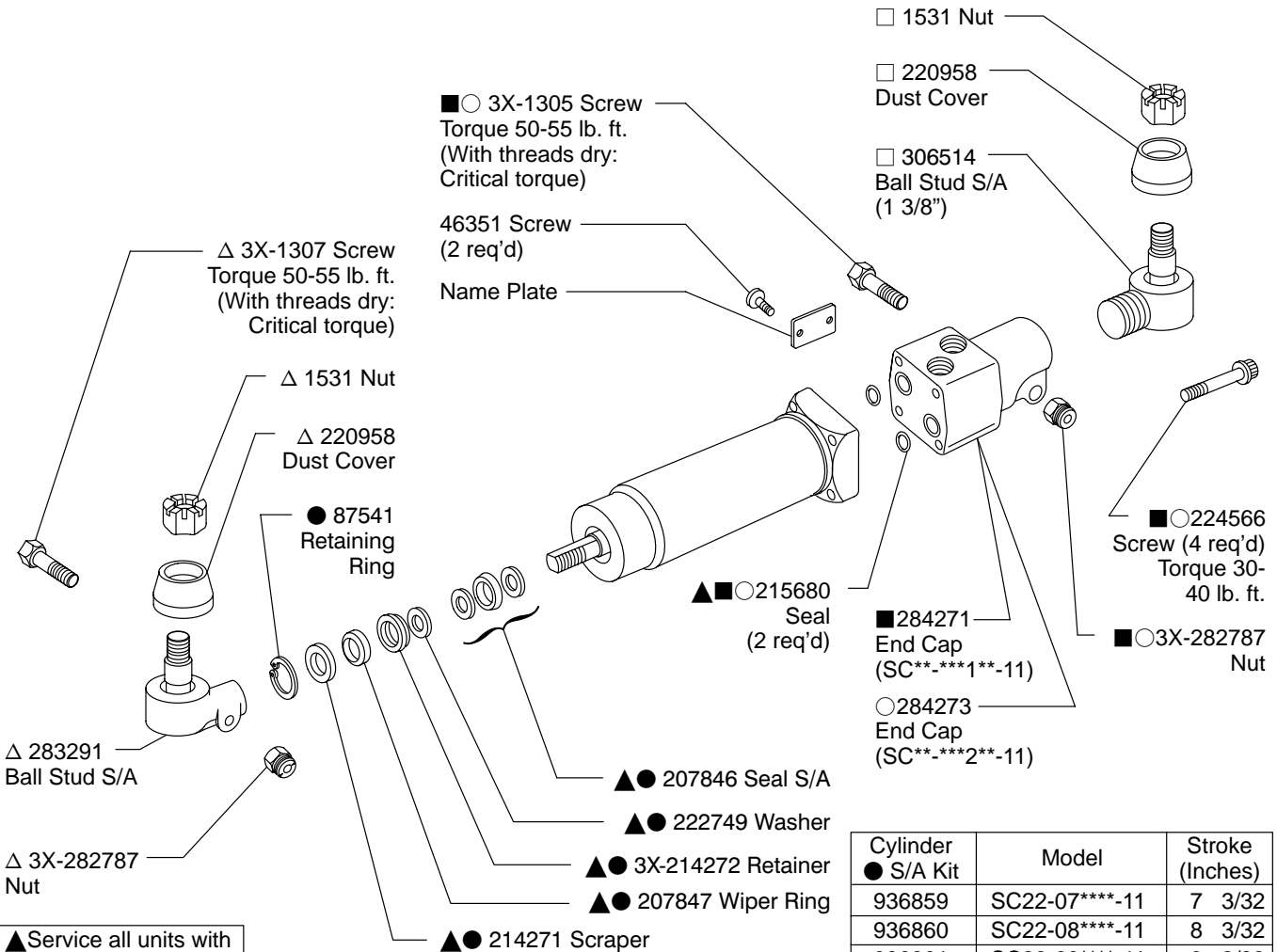
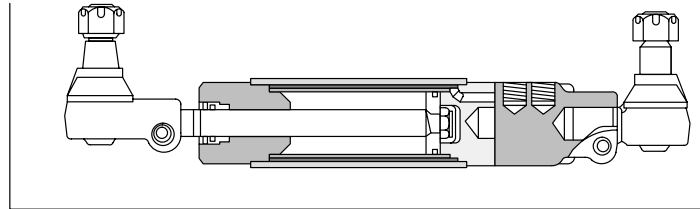

▲ Service all units with F3 Seal Kit 922628

○ Included in 922922 End Cap Kit (1 3/8")

■ Included in 922941 End Cap Kit (1 1/8")

△ Included in 922945 Ball Stud Kit

□ Included in 923218 Ball Stud Kit

Cylinder S/A Kit	Model	Stroke (Inches)
936859	SC22-07****-11	7 3/32
936860	SC22-08****-11	8 3/32
936861	SC22-09****-11	9 3/32
936862	SC22-10****-11	10 3/32
936863	SC22-11****-11	11 3/32
936926	SC22-12****-11	12 3/32
936927	SC22-13****-11	13 3/32
936928	SC22-14****-11	14 3/32
936929	SC22-15****-11	15 3/32
936930	SC22-16****-11	16 3/32
936931	SC22-17****-11	17 3/32

# Model Code

**SC 22 - \*\* \* \* \* \* - 11**

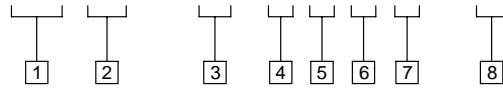

**1 Steering Cylinder**

**2 Cylinder Bore Diameter**

(1/8 inch increments)  
22 - 2.750 inch diameter

**3 Stroke**  
(Inches)

- 06 - 6 3/32 inch
- 07 - 7 3/32 inch
- 08 - 8 3/32 inch
- 09 - 9 3/32 inch
- 10 - 10 3/32 inch
- 11 - 11 3/32 inch
- 12 - 12 3/32 inch
- 14 - 14 3/32 inch
- 15 - 15 3/32 inch
- 16 - 16 3/32 inch
- 17 - 17 3/32 inch

**4 Rod End Mounting**

- N - No attachments
- A - Horizontal ball stud S/A - Steel seat
- B - Horizontal ball stud S/A - Nylon seat

**5 End Cap**

- N - No end cap
- 1 - 20 USgpm  
1.125 12 UNF female thread  
(No ball stud S/A available)
- 2 - 20 USgpm - UNF female thread

**6 Head End Mounting**

- N - No attachments
- C - Horizontal ball stud S/A - Nylon seat - 1.375-12 UNF thread  
(for #2 end cap only)

**7 Head End Mounting Position**

- N - No position or attachment
- W - Opposite port connections
- X - 90° counterclockwise from port connection
- Y - In line with port connection
- Z - 90° clockwise from port connections

**8 Design**

For satisfactory service life of these components, use full flow filtration to provide fluid which meets ISO cleanliness code 20/18/15 or cleaner. Selections from Eaton OFP, OFR and OFRS filter series are recommended.

Printed in U.S.A.